

## Triangle link for webbing KB type 1

---

### Product information

The Triangle Link for Webbing KB Type 1 is a robust male component designed for use in textile slings. It is intended for sling terminations, providing a stable and secure termination. Made from durable materials, the D-ring is load-resistant and offers reliability in demanding work conditions. This product is ideal for industrial and construction lifting applications, meeting high standards of quality and safety. [... Read more](#)

---



**Marking:** According to standard

**Standard:** EN 1677

**Safety factor:** 6:1

## Triangle link for webbing KB type 1

### Blueprint

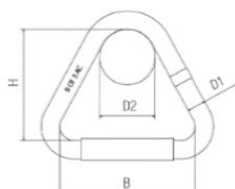

### Technical data

Код товара	Код	WLL ton	Dimensions mm	D1 mm mm	D2 mm mm	B mm	H mm	Bec kg
42040443B	KB01	1	45x60 (BxH)	12	30	45	60	0,2
42040444B	KB02	2	70x80 (BxH)	16	60	70	80	0,5
42040445B	KB03	3	106x120 (BxH)	20	90/100	106	120	1,1
42040446B	KB04	4	133x130 (BxH)	23	120	133	130	1,6
42040447B	KB05	5	170x180 (BxH)	26	150	170	180	2,69
42040448B	KB06	6	206x180 (BxH)	28	180	206	180	3
42040449B	KB08	8	280x200 (BxH)	32	240	280	200	5,8
42040450B	KB010	10	330x250 (BxH)	35	300	330	250	8,2