

Geared Trolley Powertex PGT-S2

Product information



POWERTEX

Powertex Geared Trolley PGT-S2 is a high quality, durable low built push trolley that is easy to install on horizontal beams and rails.

The trolleys can be used for I-beams with plane flanges (such as IPE, HEA or HEB types) or beams with sloping flanges (such as INP-beams).

The trolley can easily be positioned along the beam using the hand chain thanks to high quality steel wheels with bearings.

Features:

- Safe - All Powertex trolleys are proof load tested 1,5 x WLL
- Mechanical stops integrated in the design to prevent derailing
- Equipped with connection plate with eye to hoist's upper hook or direct connection
- Connection plate can be turned 90 degrees to allow direct connection to Powertex S2 hoists without need of intermediate hook/eye
- Rubber bumpers to absorb shock loads on impact to rail ending
- Equipped with RFID for quick registration and maintenance
- Marked with QR code to allow access to User manuals at any time
- PGT-S2 is easy to mount and dismount on a horizontal rail or beam
- The 3 piece design makes installation quick and ergonomically
- The shaft is easily locked using the Lock plate (No need to use large castle nut nor collar pins)
- Wheel shafts are robotic welded for high quality weld seams
- Large steel wheels equipped with double sided sealed bearings that do not need ... [Read more](#)

Marking: According to standard, CE-marked

Standard: EN 13157, AS 1418.2

Safety factor: 4:1

Geared Trolley Powertex PGT-S2

Blueprint

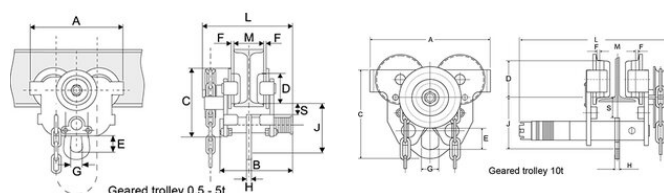

Technical data

| Kod towaru | WLL ton | Beam width mm | Model | Minimum radius mm | Hand chain length m | A mm | B mm | C mm | D mm | E mm | F mm | G mm | H mm | J mm | L mm | S mm | Beck kg |
|----------------|---------|---------------|--------|-------------------|---------------------|------|------|------|------|------|---------|------|------|------|------|------|---------|
| 16.05PGTS2005 | 0,5 | 50-135 | PGT-S2 | 800 | 3 | 205 | 198 | 150 | 55 | 30 | 1,5 - 2 | 28 | 8 | 111 | 239 | 27 | 8 |
| 16.05PGTS2005B | 0,5 | 130-215 | PGT-S2 | 800 | 3 | 205 | 278 | 150 | 55 | 30 | 1,5 - 2 | 28 | 8 | 111 | 319 | 27 | 8,8 |
| 16.05PGTS2005C | 0,5 | 215-300 | PGT-S2 | 800 | 3 | 205 | 363 | 150 | 55 | 30 | 1,5 - 2 | 28 | 8 | 111 | 404 | 27 | 9,6 |
| 16.05PGTS2010 | 1 | 55-140 | PGT-S2 | 1 000 | 3 | 242 | 211 | 174 | 68 | 30 | 1,5 - 2 | 32 | 10 | 118 | 254 | 28 | 12,4 |
| 16.05PGTS2010B | 1 | 140-215 | PGT-S2 | 1 000 | 3 | 242 | 286 | 174 | 68 | 30 | 1,5 - 2 | 32 | 10 | 118 | 329 | 28 | 13,4 |
| 16.05PGTS2010C | 1 | 215-300 | PGT-S2 | 1 000 | 3 | 242 | 371 | 174 | 68 | 30 | 1,5 - 2 | 32 | 10 | 118 | 414 | 28 | 14,7 |
| 16.05PGTS2020 | 2 | 65-155 | PGT-S2 | 1 100 | 3 | 270 | 238 | 194 | 80 | 49 | 1,5 - 2 | 40 | 12 | 147 | 277 | 27 | 18,1 |
| 16.05PGTS2020B | 2 | 150-230 | PGT-S2 | 1 100 | 3 | 270 | 313 | 194 | 80 | 49 | 1,5 - 2 | 40 | 12 | 147 | 352 | 27 | 19,3 |
| 16.05PGTS2020C | 2 | 230-300 | PGT-S2 | 1 100 | 3 | 270 | 383 | 194 | 80 | 49 | 1,5 - 2 | 40 | 12 | 147 | 422 | 27 | 20,5 |
| 16.05PGTS2030 | 3 | 90-160 | PGT-S2 | 1 300 | 3 | 325 | 246 | 234 | 100 | 60 | 2 - 3 | 49 | 14 | 177 | 287 | 29 | 30,3 |
| 16.05PGTS2030B | 3 | 160-230 | PGT-S2 | 1 300 | 3 | 325 | 316 | 234 | 100 | 60 | 2 - 3 | 49 | 14 | 177 | 357 | 29 | 31,9 |
| 16.05PGTS2030C | 3 | 230-300 | PGT-S2 | 1 300 | 3 | 325 | 386 | 234 | 100 | 60 | 2 - 3 | 49 | 14 | 177 | 427 | 29 | 33,5 |
| 16.05PGTS2050 | 5 | 90-180 | PGT-S2 | 1 500 | 3 | 370 | 280 | 267 | 110 | 79 | 2 - 3 | 59 | 16 | 219 | 320 | 29 | 46,5 |
| 16.05PGTS2050B | 5 | 180-230 | PGT-S2 | 1 500 | 3 | 370 | 330 | 267 | 110 | 79 | 2 - 3 | 59 | 16 | 219 | 370 | 29 | 48,2 |
| 16.05PGTS2050C | 5 | 230-300 | PGT-S2 | 1 500 | 3 | 370 | 400 | 267 | 110 | 79 | 2 - 3 | 59 | 16 | 219 | 440 | 29 | 50,6 |
| 16.05PGTS2100 | 10 | 124-305 | PGT-S2 | 2 000 | 3 | 442 | - | 396 | 136 | 137 | 2 - 3.5 | 92 | 30 | 190 | 525 | 45 | 94 |