

## Foundry Hook GHK/S Grade 10 - Clevis

### Product information



Foundry Hooks are hooks with a bigger opening without safety latch often used in foundries.

... [Read more](#)

**Material:** Alloy steel.

**Marking:** According to standard, CE-marked

**Temperature range:** -40°C up to 380°C

**Finish:** Violet powder coated.

**Standard:** EN 818-4

**Note:** Always verify if hooks without safety latch are allowed for your application.

**Warning:** Not to be heat-treated.

**Safety factor:** 4:1

**Grade:** 10

## Foundry Hook GHK/S Grade 10 - Clevis

### Blueprint

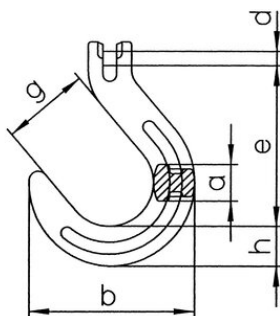

### Technical data

Part code	Code	WLL ton	EWL mm	For chain Ø mm	a mm	b mm mm	dmm mm	e mm mm	g mm mm	h mm mm	Weight kg
42060001B	GHK/S-8-10	2.5	120	8	25	118	10	120	64	29	1.04
42050587B	GHK/S-10-10	4	140	10	32	143	12.5	140	76	35	1.74
42050588B	GHK/S-13-10	6.7	170	13	40	170	16	170	89	42	3.38