

Lifting swivel with ball bearing LEIKSS, grade 80

Product information



Lubricated easily rotating swivels for use with lifting chains. Rotates easily also with full load. Equipped with large eye / eye ends.

... [Read more](#)

Material: Steel

Marking: According to standard, CE-marked

Temperature range: -40 - (+)200°C / 400°C = WLL 75%

Finish: Painted, yellow/white

Standard: EN 1677-1

Note: Two models

Warning: Not to be heat-treated

Safety factor: 4:1

Lifting swivel with ball bearing LEIKSS, grade 80

Blueprint

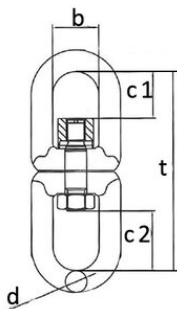

Technical data

Part code	WLL ton	For chain Ø mm	b mm mm	c1 mm	c2 mm	dmm mm	t mm	Weight kg
46090004F	1.12	6	32	33	33	12	126	0.61
46090003F	2	7/8	37	40	40	14	153	1.07
46090001F	3.2	10	39	35	65	19	168	1.5
46090002F	5	13	61	65	100	28	258	3.4
46090005F	8.2	16	73	67	67	17	281	6.44
46090006F	12.8	18-20	82	88	88	25	328	7.75