

Anchorage Point PSA-INOX-YES 8-285

Product information



- Rotates through 360° adjustable in the direction of the load.
- Load rated parts are 100% magnaflux crack detected.
- Individual forged parts and cap screw are traceable to Test Certification.
- Passed 150 kg dynamic fall testing (EU standard is 100 kg).
- Meets all requirements of the German BG BAU (Employer's insurance association of the building industry).
- Acc. to DIN EN 365 including statement for the number of load bearing persons is 1-2 persons.
- Corresponds to the European Directive for "personnel protection equipment" (89/686/ EWG).
- Suitable for permanently outdoor application.
- PSA-INOX Lifting point to be as an anchor point for personal protective equipment.

... [Read more](#)

Material: Forged stainless steel.

Marking: According to standard

Finish: Yellow powder coating

Standard: EN 795, EN 50308

Anchorage Point PSA-INOX-YES 8-285

Blueprint

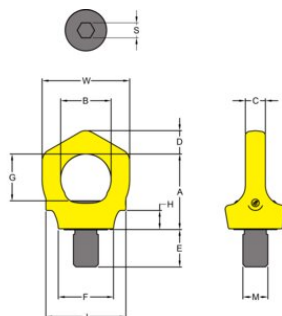

Technical data

Part code	Max. number of persons	Torque Nm	A mm	B mm	C mm	D mm	E mm	F mm	G mm	H mm	J mm	S mm	W mm	M mm	Weight kg
19.108-285-007	1	10	45	30	10	14	18	33	29	9	48	8	52	M12 x 1,75	0.2
19.108-285-015	2	30	52	35	14	16	24	44	33	12	58	10	61	M16 x 2	0.3
19.108-285-023	2	70	60	40	16	19	30	44	37	15	64	12	70	M20 x 2,5	0.6