

Shortening Claw ICE IMVK

Product information



After decades of success, the VIP-Multi-Shortening claw has been further enhanced.

- Can be captively fitted along the chain leg.
- No additional chain and coupling components are required.
- It can be moved to any position along the chain leg.
- The ideal link shaped chain pocket provides an optimal fitting for the chain thus no reduction of the WLL.
- A robust safety bolt with a spring prevents the accidental loosening of the fitted chain in both loaded and unloaded conditions.

... [Read more](#)

Material: Steel

Marking: According to standard

Temperature range: -60°C up to 200°C

Finish: Painted

Standard: DIN 5692

Note: Detailed handling instructions are provided.

Safety factor: 4:1

Grade: 12

Shortening Claw ICE IMVK

Blueprint

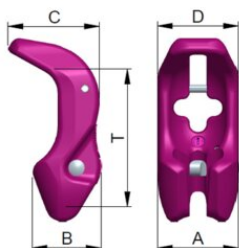

Technical data

Code	Chain diameter mm	WLL ton	A mm	B mm	C mm	D mm	T mm	Weight kg
IMVK 6	6	1.8	38	32	41	35	66	0.28
IMVK 8	8	3	47	40	54	47	88	0.61
IMVK 10	10	5	60	51	67	60	110	1.6
IMVK 13	13	8	77	65	87	77	143	2.6
IMVK 16	16	12.5	95	81	110	95	176	4.8