

Triangle link for webbing DB type 2

Produktinformation

The Triangle Link for Webbing DB Type 2 is a robust female component designed for use in textile slings. It is intended for sling terminations, providing a stable and secure termination. Made from durable materials, the D-ring is load-resistant and offers reliability in demanding work conditions. This product is ideal for industrial and construction lifting applications, meeting high standards of quality and safety. [... Read more](#)



Kennzeichnung: nach Norm
Standard: EN 1677

Sicherheitsbeiwert: 6:1

Triangle link for webbing DB type 2

Blaupause

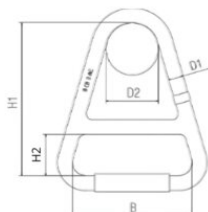

Technische Daten

Artikel-Nr.	Code	Tragfähigkeit t	Abmessungen (mm)	D1 mm mm	D2 mm mm	Bmm mm	H1 mm mm	H2 mm mm	Gewicht (kg)
42040451B	DB01	1	80x100 (BxH1)	12	30	80	100	25	0,4
42040452B	DB02	2	115x146 (BxH1)	16	60	115	146	40	1
42040453B	DB03	3	160x205 (BxH1)	20	90/100	160	205	55	2
42040454B	DB04	4	200x218 (BxH1)	23	120	200	218	55	3,1
42040455B	DB05	5	240x300 (BxH1)	26	150	240	300	80	5
42040456B	DB06	6	284x284 (BxH1)	28	180	284	284	80	5,4
42040457B	DB08	8	370x332 (BxH1)	32	240	370	332	90	10,2
42040458B	DB10	10	424x385 (BxH1)	35	300	424	385	100	13,8