

Battery Drill Winch WA200

Produktinformation



This battery drilling machine winch is a user-friendly winch and is often used as a back-up system. If the power fails and you want to move a heavier load quickly and effectively, the use of a battery powered drill offers a solution. The winch is very compact and can be mounted both against the wall and on the floor. Ideal for smaller work.

- Robust and safe lifting and pulling winch operated with battery drill
- Flexible coupling attachment for battery drill
- Self braking worm gear system
- Suitable for wall or floor (console) mounting
- Suitable for short lifting lengths
- Maintenance free aluminum closed gear box
- In compliance with DIN 15020
- Painted frame with thickness 60 - 80 micron in 1 layer (RAL 7035 - grey) and zinc-plated finished cable drum

... [Read more](#)

Kennzeichnung: nach Norm, CE-Kennzeichnung

Standard: EN 13157

Sicherheitsbeiwert: 4:1

Battery Drill Winch WA200

Blaupause

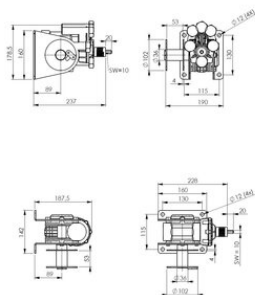

Technische Daten

Code	Tragfähigkeit t	Seil Ø mm	Seilaufnahme (m)	Tragfähigkeit oberste Lage (kg)	Hubgeschwindigkeit m/min.	Gewicht (kg)
WA200	0,2	4	18	90	0,8	6