

Lifting Point RUD W-ABA

Produktinformation



- 4:1 safety against breaking
- Patented markings for easy determination for withdraw of service
- Tempered base body which is wear-resistant
- 100% Electro-magnetic crack detection tested

... [Read more](#)

Kennzeichnung: nach Norm
Standard: EN 1677-1

Sicherheitsbeiwert: 4:1

Lifting Point RUD W-ABA

Blaupause

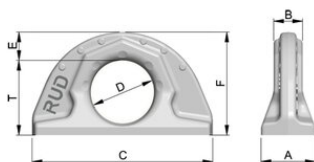

Technische Daten

Artikel-Nr.	Tragfähigkeit t	A mm	B mm	C mm	D mm	E mm	F mm	T mm	Gewicht (kg)
46040212B	0,8	22	12	70	32	12	50	32	0,2
46040013B	1,6	30	16	100	35	16	57	42	0,45
46040052B	3,2	41	23	137	50	21	80	59	1,15
46040163B	5	51	27	172	60	28	99	72	2,26
46040113B	10	70	38	228	80	35	130	95	5,37
46040214B	20	90	52	272	115	40	175	135	10,72
46040215B	31,5	108	64	320	130	50	204	154	18,33